

Make a Backwards Number Line

Step 1: Trace the numbers with a crayon.

Step 2: Cut out the numbers on all the pages.

Step 3: Glue them together in a number line. Start at 10 and count back.

The number line should look like this when completed.

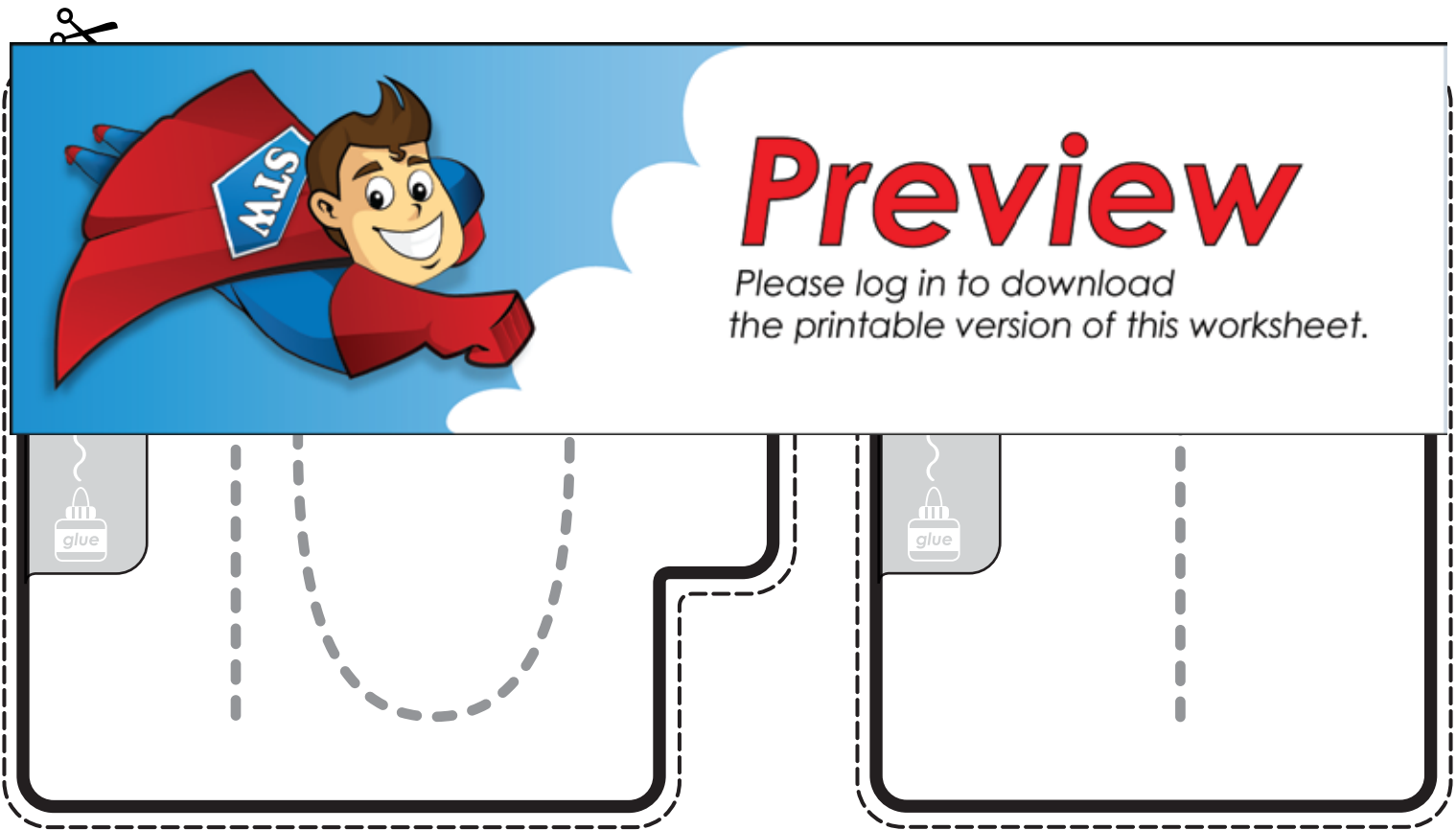

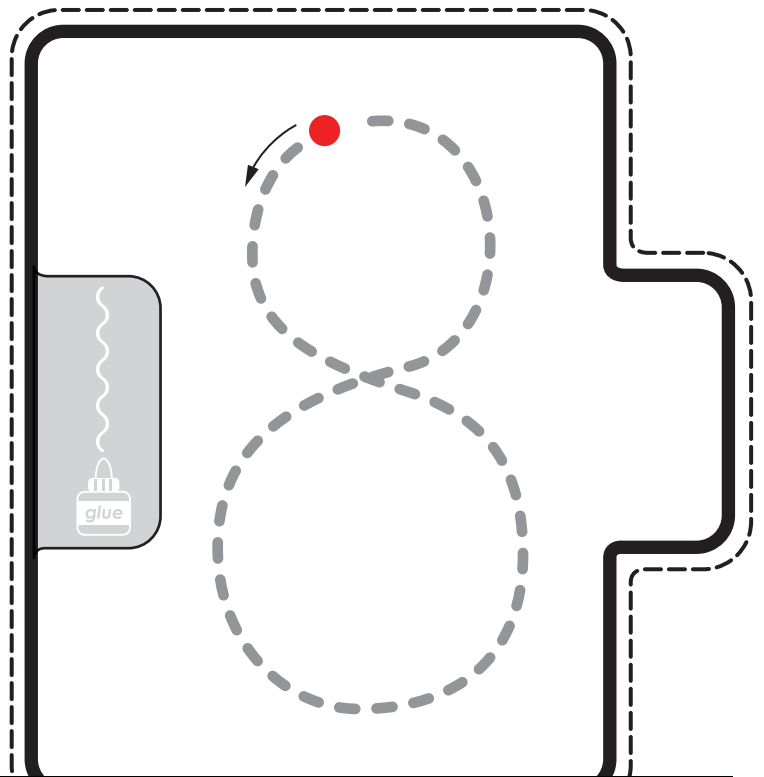
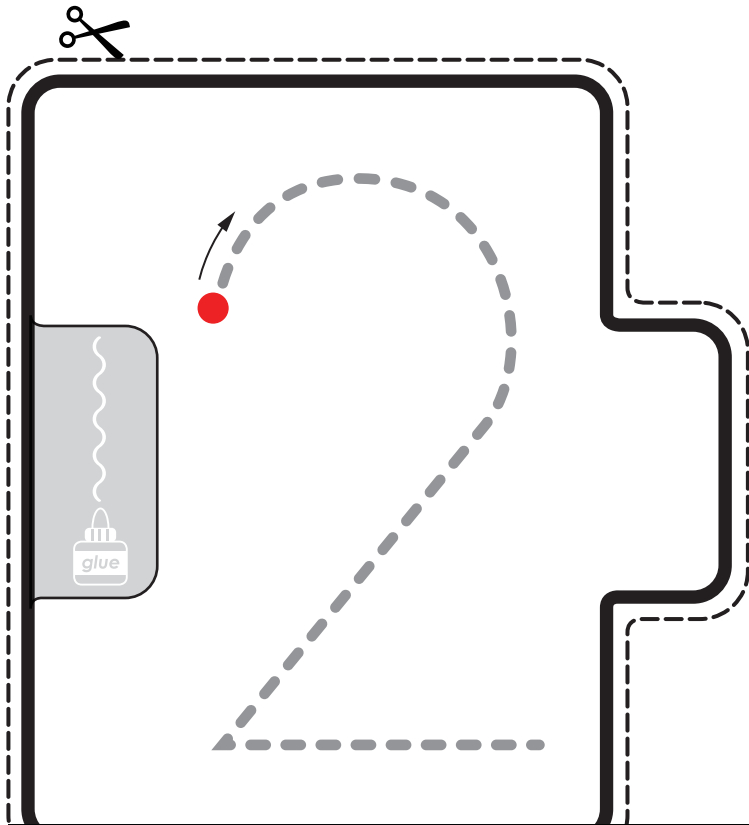

Preview

Please log in to download the printable version of this worksheet.

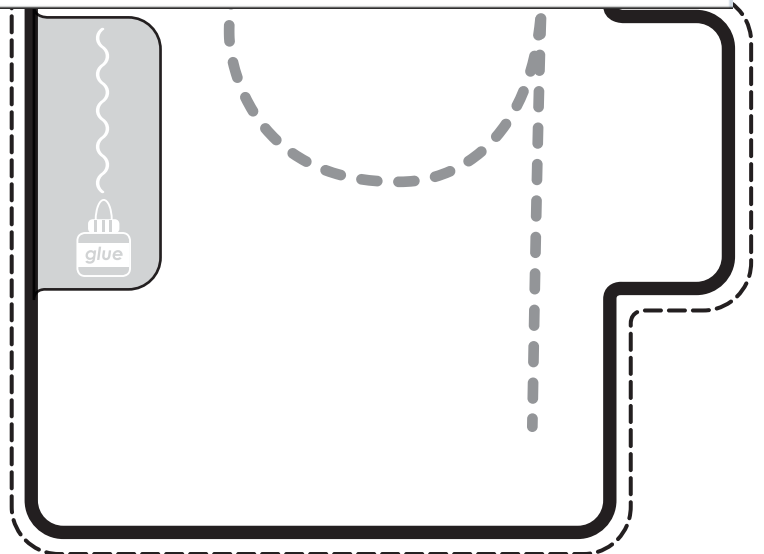
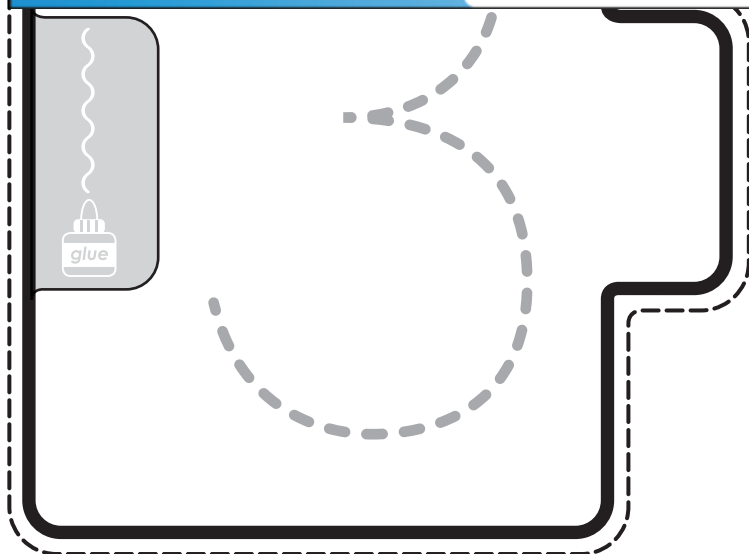

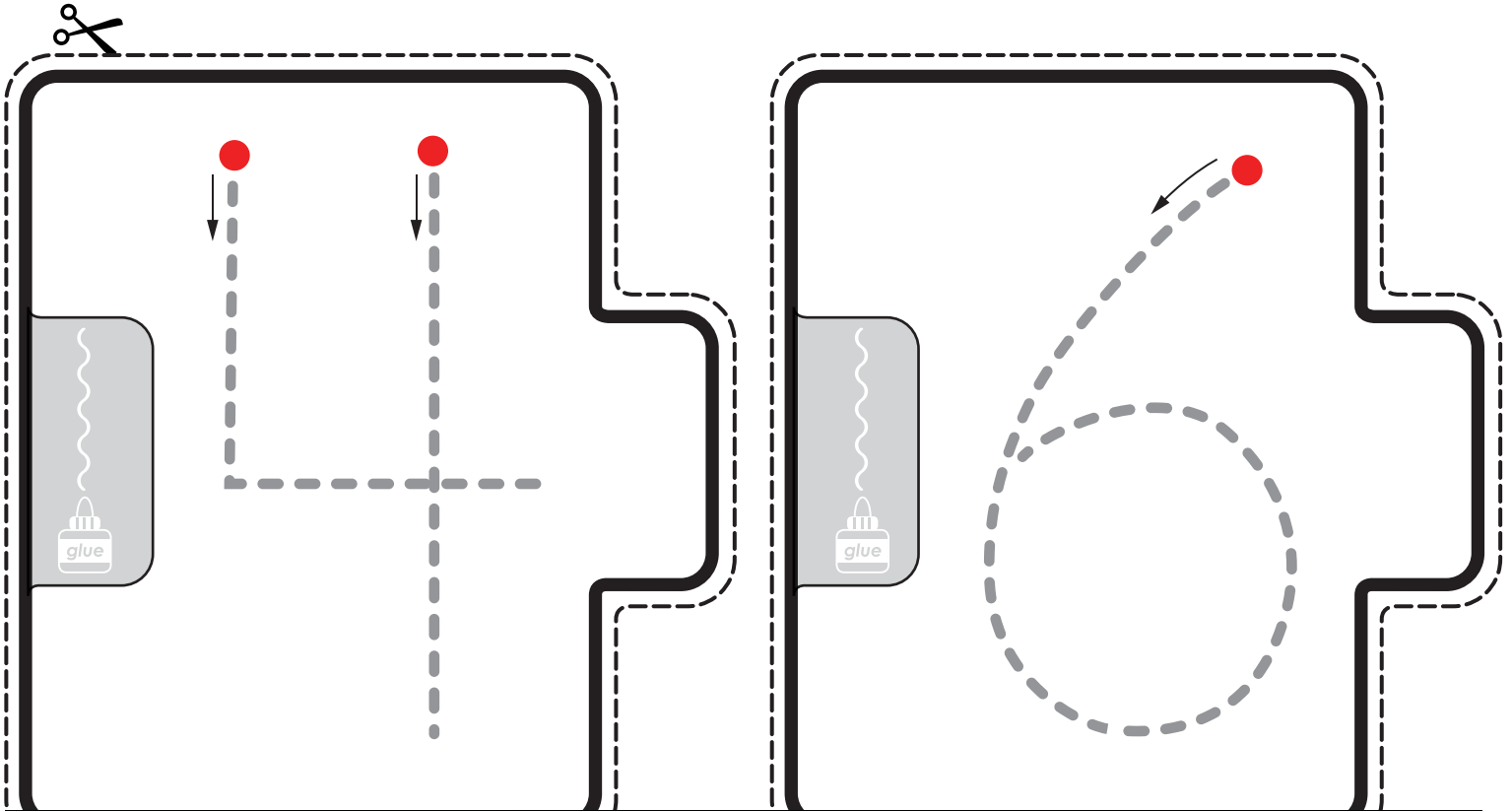

Preview
Please log in to download
the printable version of this worksheet.

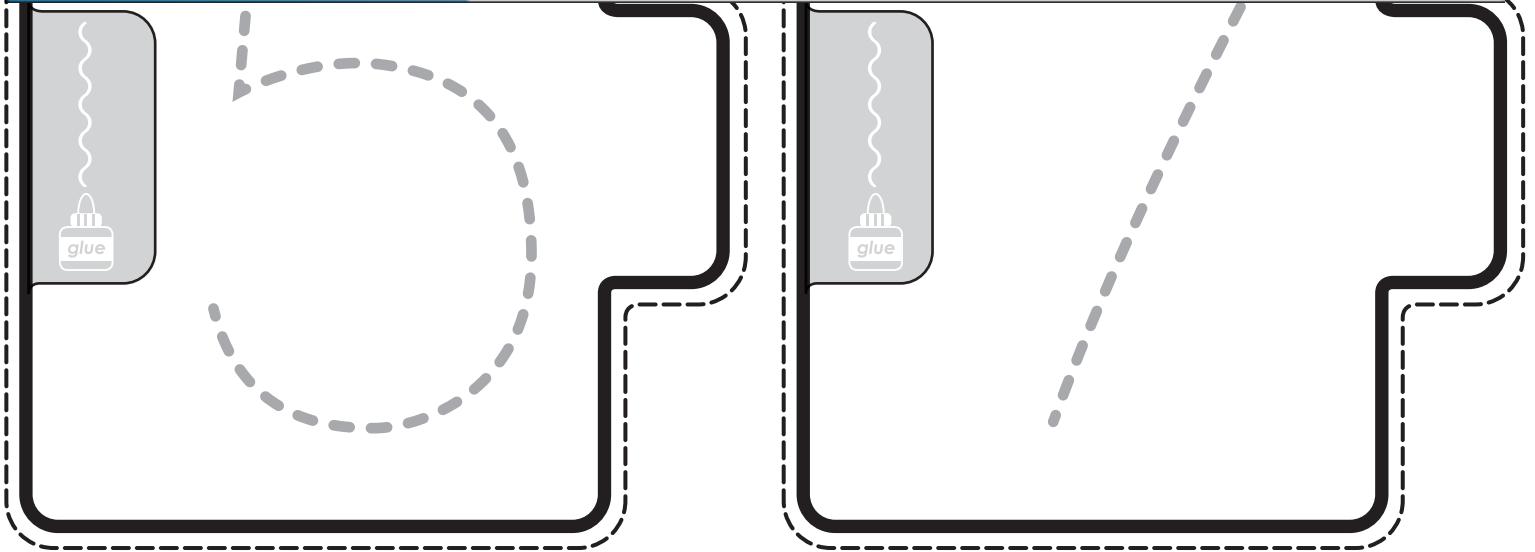
A central banner featuring a cartoon superhero character on the left and a white text box on the right. The superhero is wearing a red cape and a blue suit with 'MJS' on his chest. The text box contains the word 'Preview' in large red letters and a message to log in to download the printable version.



Counting Backwards

Name: _____



Preview

Please log in to download
the printable version of this worksheet.