

Name: \_\_\_\_\_

# First Thanksgiving Diorama

## Directions:

**Step 1:** Color the backdrop and base for the diorama.

**Step 2:** Color the cut outs. Be sure to write your name name on the sign.

**Step 3:** Carefully fold the backdrop and base along the **dotted line**.

**Step 4:** Carefully cut out the pieces along the **dotted lines**.

**Step 5:** Fold the tabs on the Thanksgiving cut outs **backward**.

**Step 6:** Glue the tabs on each piece to the base of the diorama:

- Glue the sign to the back of the backdrop making sure it can be seen and read.

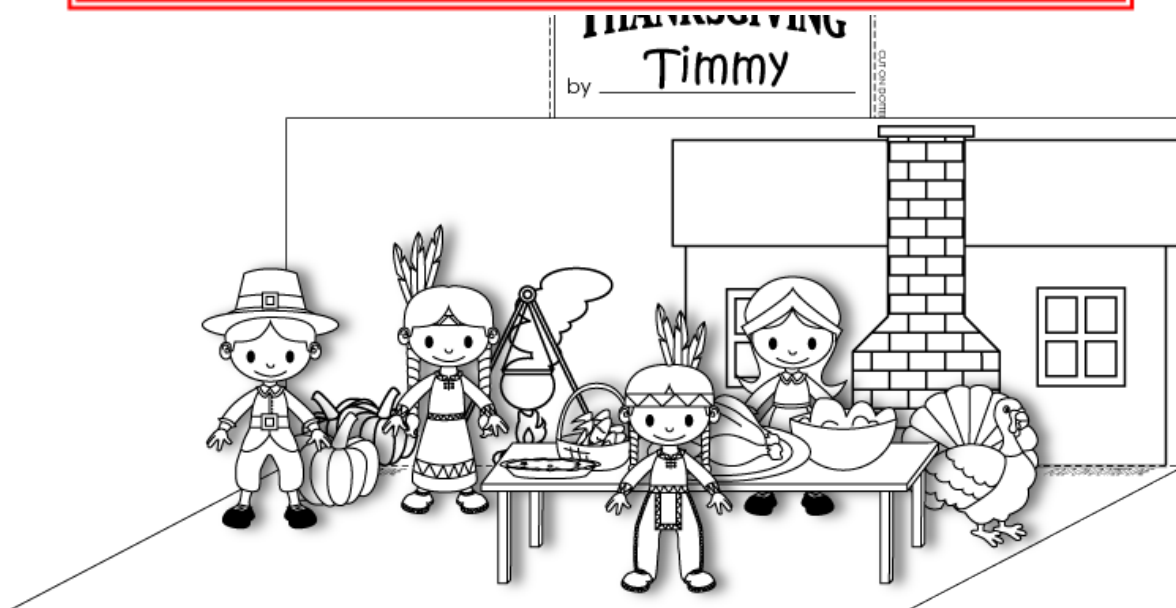

**\*Note to teachers:** For best results, reproduce the graphics pages on card stock.

FOLD ON DOTTED LINE

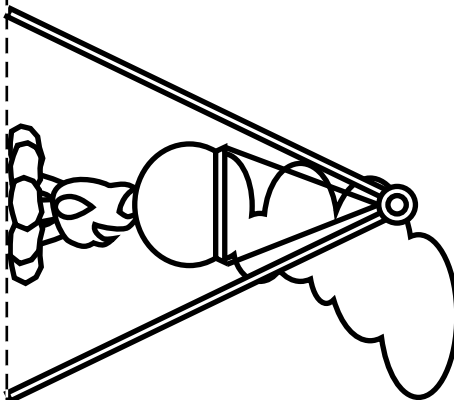
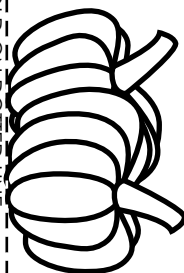

**PREVIEW**

Please log in or register to download the printable version of this worksheet

FOLD ON DOTTED LINE

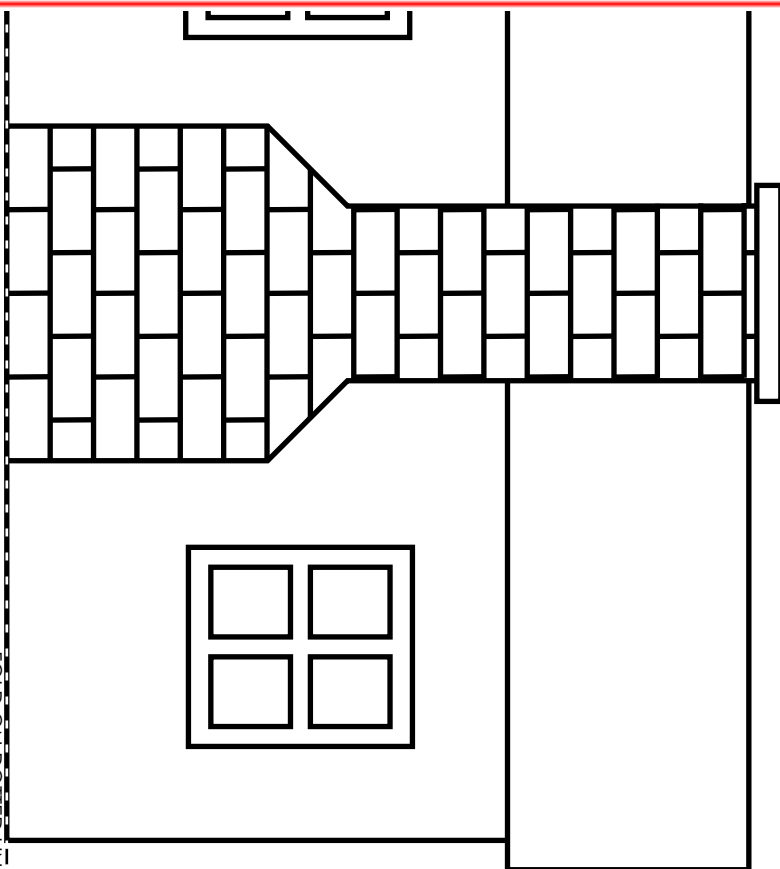

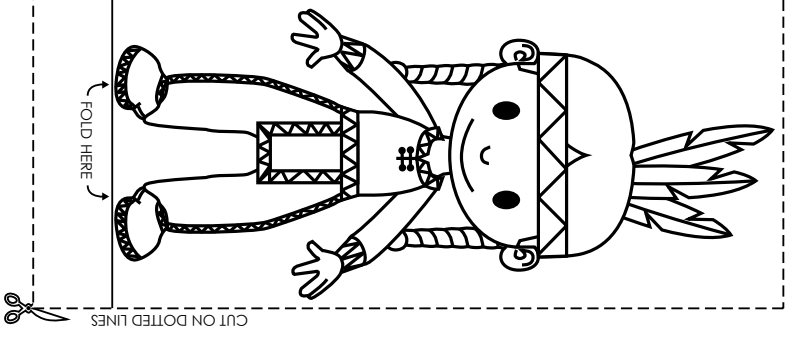
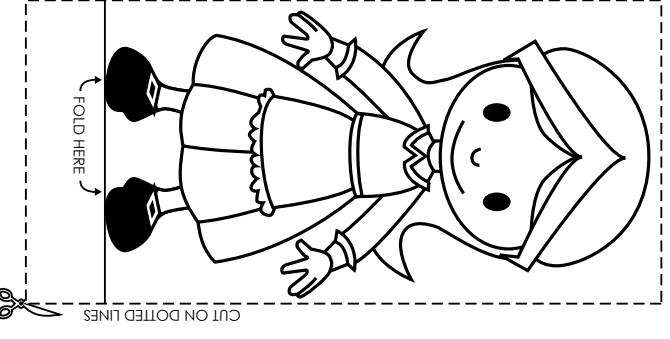
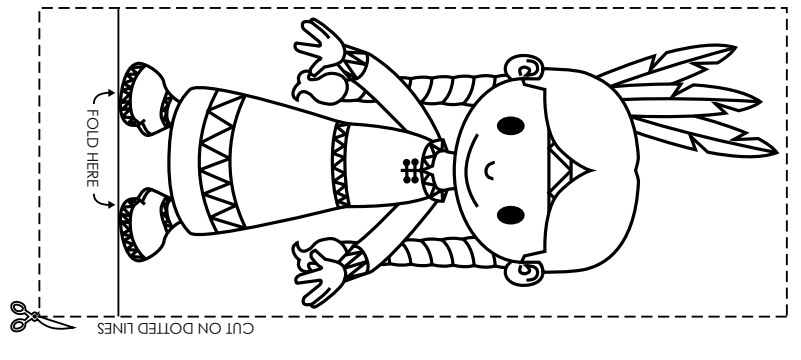
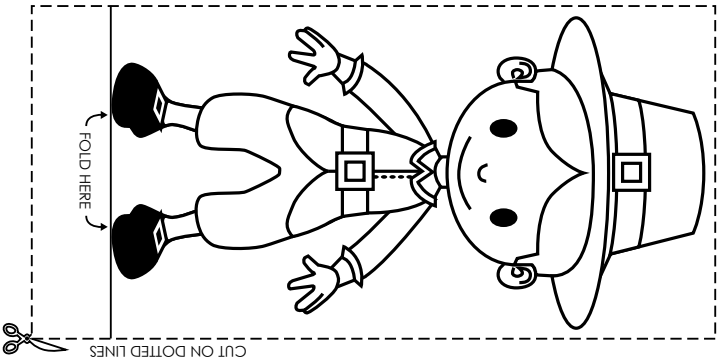

**PREVIEW**

Please log in or register to download the printable version of this worksheet.

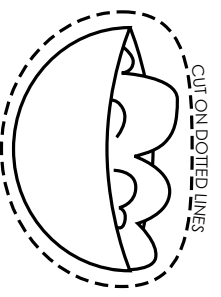
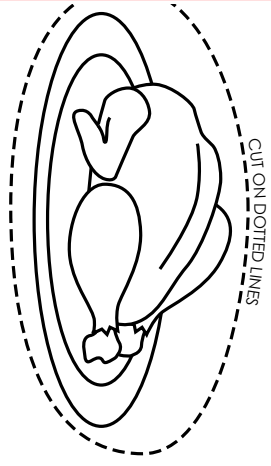
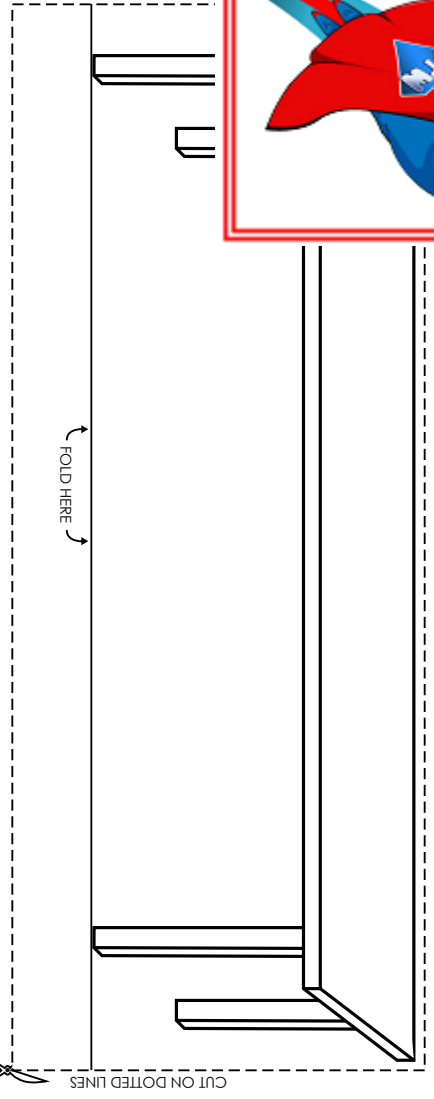
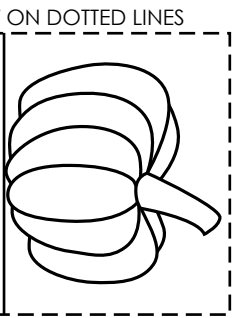
A cartoon superhero character with a red suit and blue cape, holding a basket of food.

THE FIRST  
**THANKSGIVING**

by \_\_\_\_\_

Write your name on the line above.  
Glue this tab to the back of the display. Make sure to glue it high enough to show over the top of the scene.

CUT ON DOTTED LINES